

## Product Discontinuation Notice

### SL Series Micro Switch[Roller Hinged Lever type]

Thank you for your continued support of Sunmulon micro switch, SL series.

Production of the Roller Hinged Lever type will be discontinued on April, 2018. The details are as follows.

#### Discontinued Model

#### SL series Roller Hinged Lever type SL-□□W5

Please consider alternative to standard hinged lever type (SL-□□W1) or simulated hinged lever type (SL-□□W3).

#### SL Micro Switch

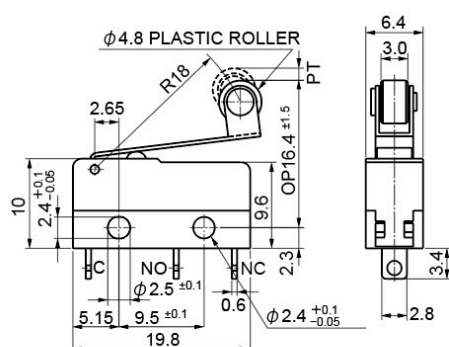

Type	Operating Characteristics				
	OF (g)	RF (g)	PT (mm)	OT (mm)	MD (mm)
SPDT	Max.	Min.	Max.	Min.	Max.
SL-1NW5	0.33N (34gf)	0.05N (5gf)	3.2	1.2	1.2
SL-2NW5	0.49N (50gf)	0.07N (7gf)	3.2	1.2	1.2
SL-3NW5	0.25N (25gf)	0.04N (4gf)	3.2	1.2	1.2
SL-4NW5	0.15N (15gf)	0.02N (2gf)	3.2	1.2	1.2

#### ORDERING CODE

SL — □ N □ □ □

##### ● OF

1	Max. 0.98N {100gf}
2	Max. 1.47N {150gf}
3	Max. 0.78N { 80gf}
4	Max. 0.45N { 45gf}

##### ● Terminals

None	Solder
P	#110 Tab

##### ● Contact Materials

None	Silver
------	--------

##### ● Actuator

None	Pin Plunger
W1	Standard hinged lever
W3	Simulated hinged lever
W5	Roller hinged lever